

# AIR-CHANNEL® STAR

(WITHOUT SUBFLOOR)



*STABLE. STRONG. SECURE.*

*IN EVEN THE TOUGHEST CONDITIONS*

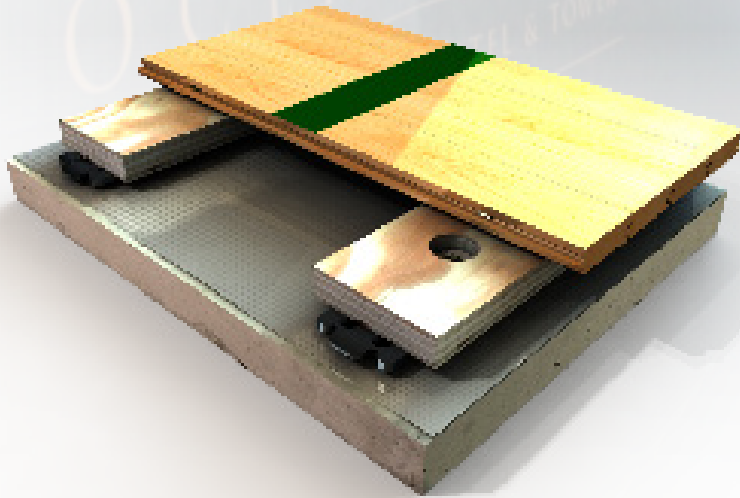

Robbins Air-Channel Star system combines anchored laminated sleepers to provide a system with dimensional stability and superior performance. The Air-Channel Star sleepers are laminated and engineered to be less susceptible to physical changes due to moisture compared to solid softwood sleepers. Air-Channel Star is an excellent choice for your gymnasium project.

- *Wide-body, low-profile, engineered sleeper anchored uniformly to concrete substrate for enhanced stability.*
- *7/8" plywood sleeper enhances performance, flexibility and uniformity and provides dramatic improvement over softwood subfloor components.*
- *Robbins' patented "Posi-Anchor"™ built-in depth stop prevents shockpad over-compression, providing uniformity and stability.*
- *7/16" (11mm) resilient EPDM Bio-Pad,™ for shock absorption and vibration control.*
- *DIN-certified, meets or exceeds all six DIN 18032-2 criteria for ball bounce, shock absorption, deflection, area of deflection, rolling load and surface friction.*



robbinsfloor.com | 1.800.543.1913

Robbins, Inc. | 4777 Eastern Avenue | Cincinnati, OH 45226

MAPLE FLOORING SYSTEMS

# AIR-CHANNEL® STAR (WITHOUT SUBFLOOR)



## Product Specifications

System Type	Anchored Resilient Sleeper
Slab Depression	2" (51mm) with 25/32" (20mm) maple 2 1/4" (57mm) with 33/32" (26mm) maple
Surface- MFMA Northern Hard Maple	Robbins Continuous Strip® XL (FJ) or Random Length (RL)
Anchorage	Concrete Anchor & Sleeve
Vapor Barrier	6 MIL Polyethylene
Subfloor Construction	7/8" thick wide body laminated sleeper
Resilience Layer	7/16" Resilient Pad
LEED Contributions	MR credit 4, 5, & 7 IEQ 4.1, 4.2, 4.3, 4.4 FSC® Lumber Available <i>*Credits are based on products selected and location of facility</i>
Optional Construction	Contact a Robbins Representative for Alternative Systems
Warranty 	1 year Industry Standard with optional Extended Warranty Program ( <i>Egis Floorlife</i> )



Wall View

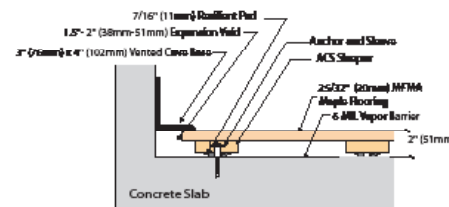

Threshold View

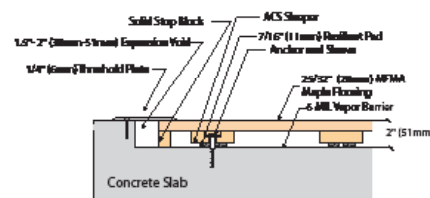

Equipment View

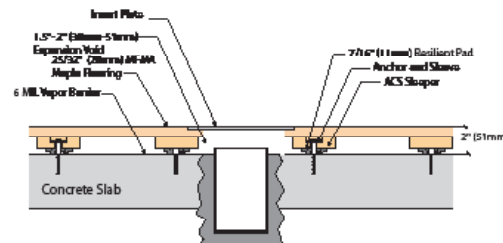

### Air-Channel Family Reference Facilities

Oklahoma University  
University of Mississippi  
Robert F. Kennedy High School  
Trump Tower- Panama  
University of Michigan



robbinsfloor.com | 1.800.543.1913

Robbins, Inc. | 4777 Eastern Avenue | Cincinnati, OH 45226