

INSTALLATION GUIDELINES

GETTING STARTED

ADDITIONAL HARDWARE NEEDED

Installation requires a few additional hardware items that aren't included with the panels and extrusions but all are easily obtainable from any hardware store. The following should be procured in quantities sufficient to accommodate the apparent scope of the project after reviewing the procedures in this guide.

- #8 x 1 5/8" drywall screws
(Any finish is acceptable and longer screws are okay but they should not be shorter)
- #8 Screw in hollow wall anchors
(Fastenal "Wall Driller" #50930 recommended)
- Construction adhesive and clear silicone

TOOLS REQUIRED

- 10" Chop saw with a fine tooth finishing blade
- 7 1/4" Skill saw with a fine tooth finishing blade
- Jig saw
- 3/8" Drill
- Impact screw driver
- 5/32" drill bit
- 3/16" Drill bit
- 4'-6' Hand held carpenters bubble level
- Self-leveling laser level *(Optional but recommended)*
- 10" portable or other table saw *(Optional but recommended)*
- Caulking gun

ESTABLISH A BASELINE

Installation begins with determining heights for floor finishes and cove or solid base and scribing a baseline where the bottom of the wall panels will finish. Care should be taken to make sure this line is true and level, the use of a self-leveling laser is highly recommended. Identify and mark all stud locations where panels will be installed and understand stud locations and construction of inside and outside corners.

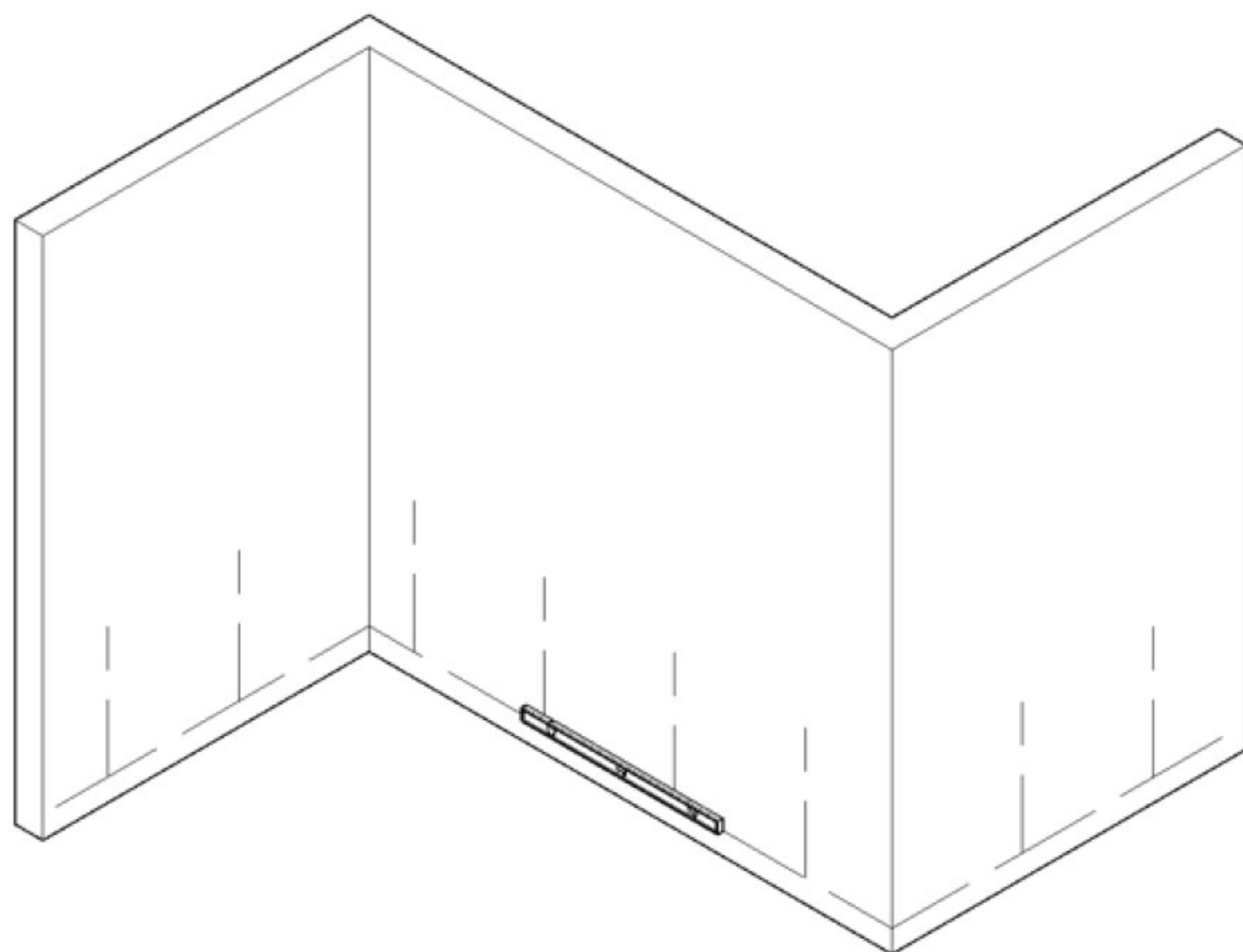

Establish level baseline and mark stud locations

INSTALL INSIDE AND OUTSIDE CORNERS

Mount inside and outside corners first. Use a drill with 5/32 pilot bit to drill trough the flat wall mounting side of the extrusion. Most extrusions have a slight V groove in the mounting leg that help steady and direct a drill bit for optimum grab. Extrusions can be mounted on either side of each corner or both if it helps keep its mounting position true and square. Because mounting in two directions isn't always possible because of stud positions in the wall, three to four fasteners on one side or the other is usually sufficient to retain corner extrusions.

If no stud is available then hollow wall anchors are needed, using the same 5/32 drill bit, hold the extrusion in the desired position and drill through the mounting leg and into the hollow wall. Using your impact driver screw in the wall anchors in the marked positions and then fasten with #8 x 1 3/4 drywall screws and leave screw heads slightly proud. The high screw heads will help to force the panels outward and create tight seams in later steps when installing the panels

Align inside and outside corners with baseline at bottom

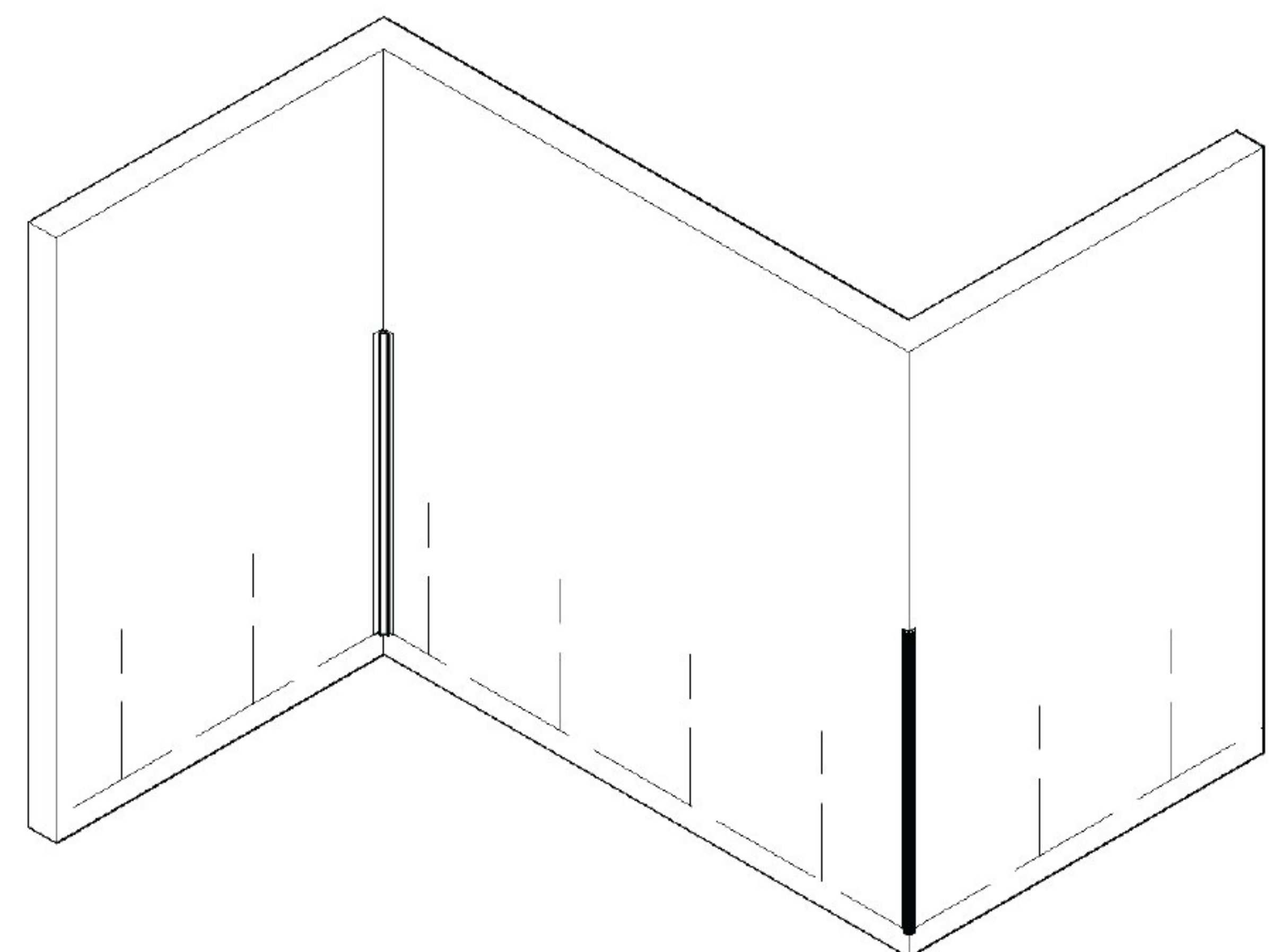

Attach using #8 x 1 3/4 drywall screws, 3 to 4 screws in one or both mounting legs is sufficient

INSTALLATION GUIDELINES

INSTALL INSIDE AND OUTSIDE CORNERS (cont.)

Establish distances between inside and outside corners and cut bottom and top "J" track using a 10" chop saw. The extrusions cut easily with a fine tooth blade on a chop saw but should be cut slow, they should be well supported and held securely while being cut.

Measure distance between outermost surfaces of profiles and determine distance to finished ends. Finished ends will be capped using the same "J" track extrusion that is used on the top and bottom and should be mitered at adjoining corners. It should be remembered that the top "J" track needed to finish off the tops of the panels will be the same size as the bottoms, cutting both top and bottom at this stage helps.

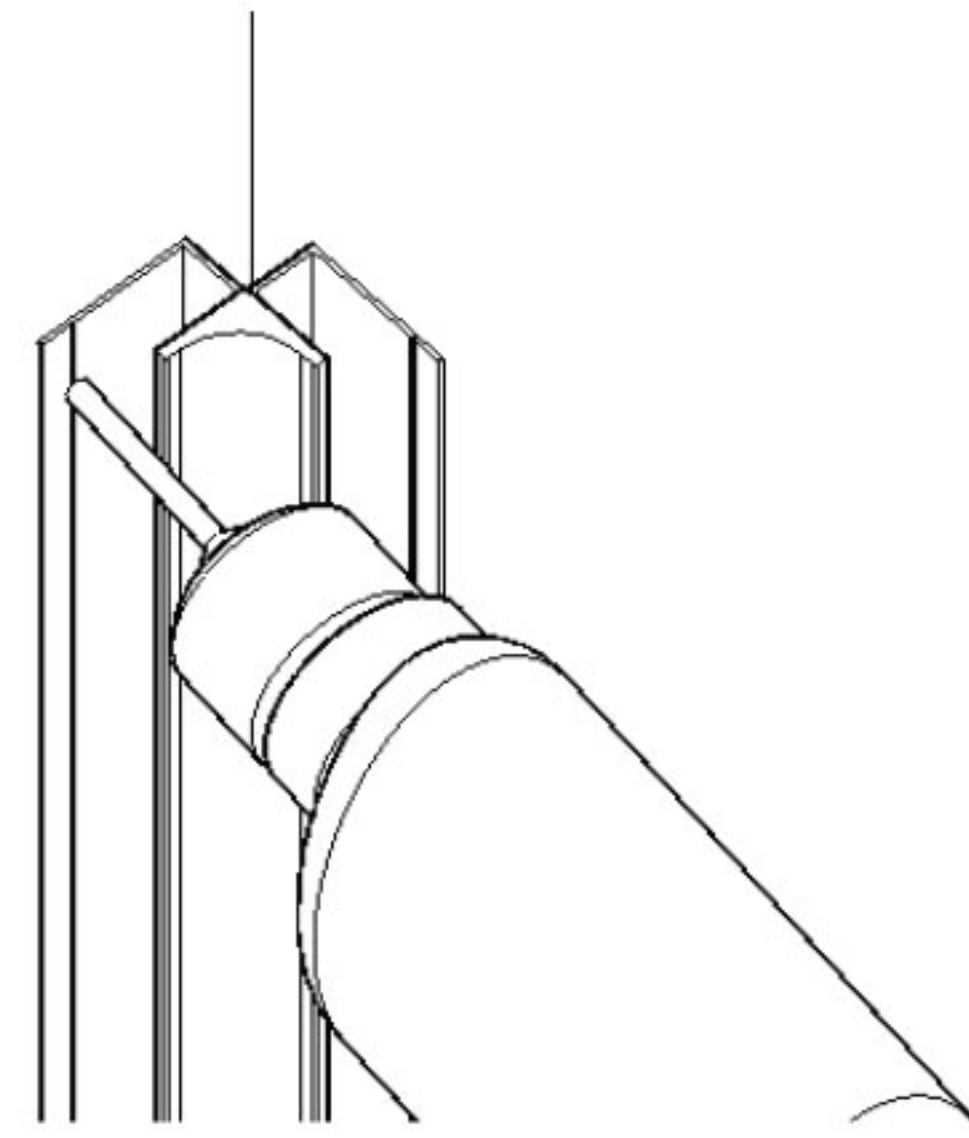

Use V groove on mounting legs to help guide drill bit



Use hollow wall anchors
When no studs are available

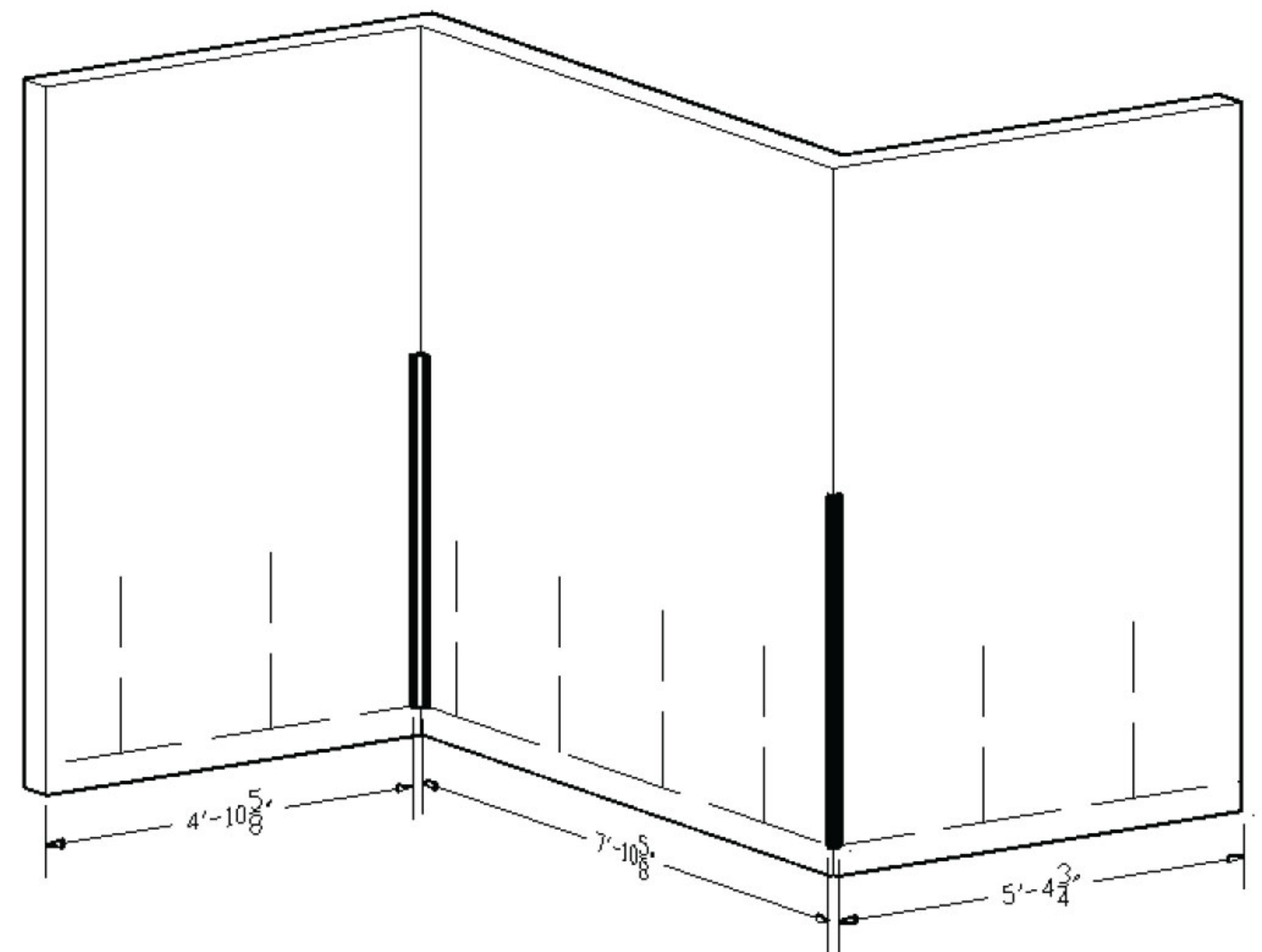

Measure distance between corners and distance to finish ends

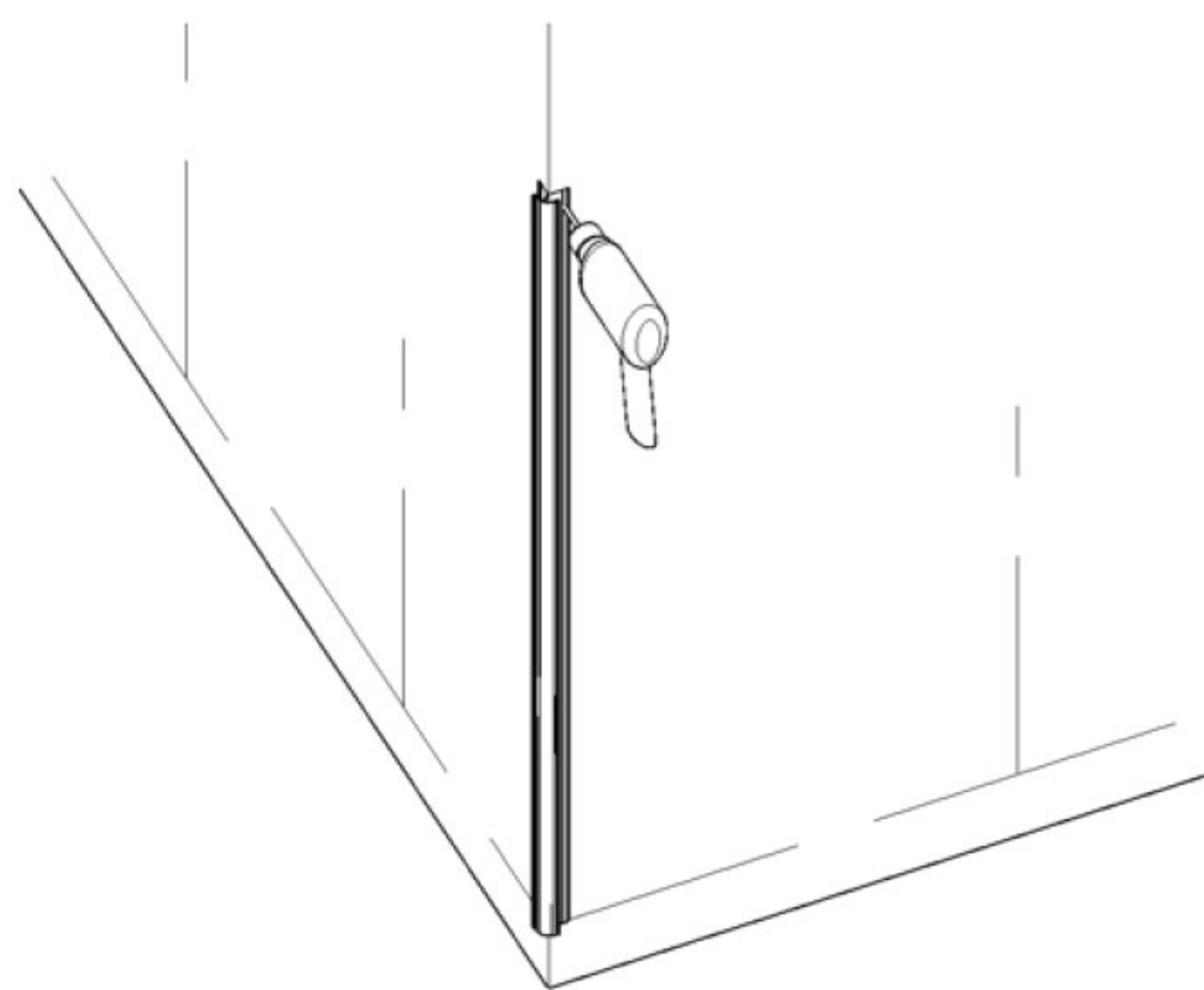

Use drill with 5/32 pilot bit to drill pilot holes through extrusion and into studs

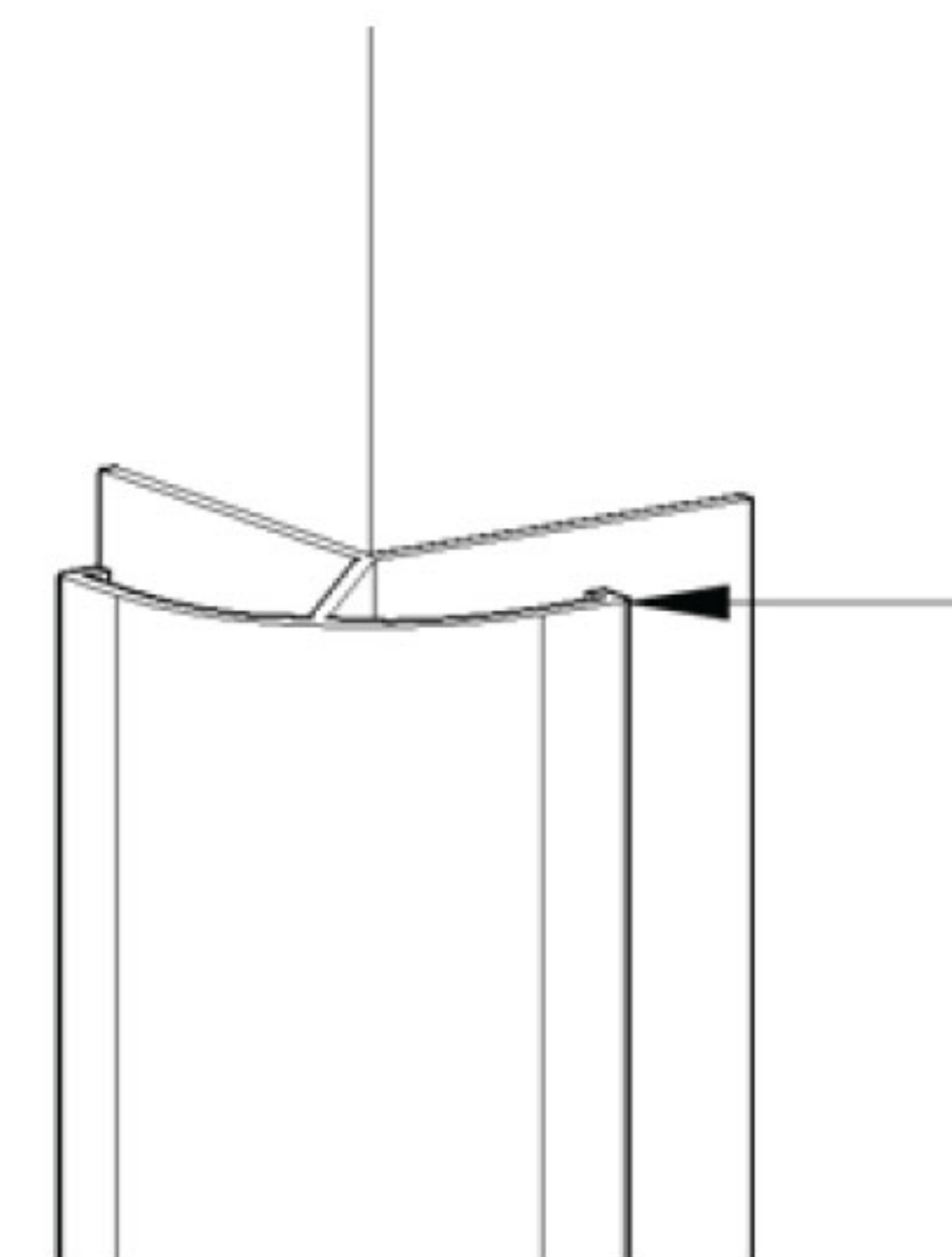

Measure from outermost surface of extrusions



INSTALLATION GUIDELINES

INSTALL INSIDE AND OUTSIDE CORNERS *(cont.)*

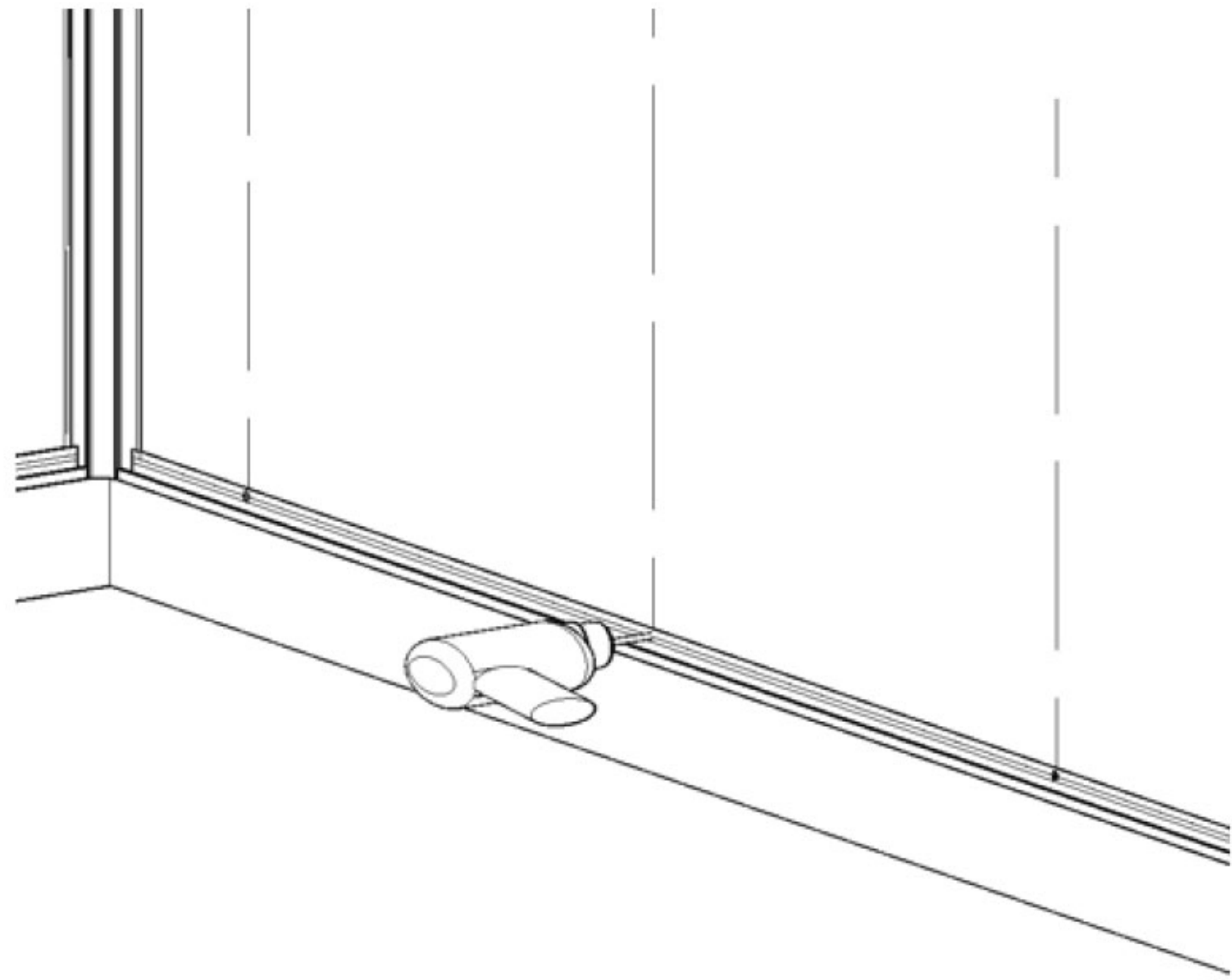

Cut bottom "J" track and check fit. Pre drill mounting leg at stud locations and fasten with #8 x 1 3/4 drywall screws

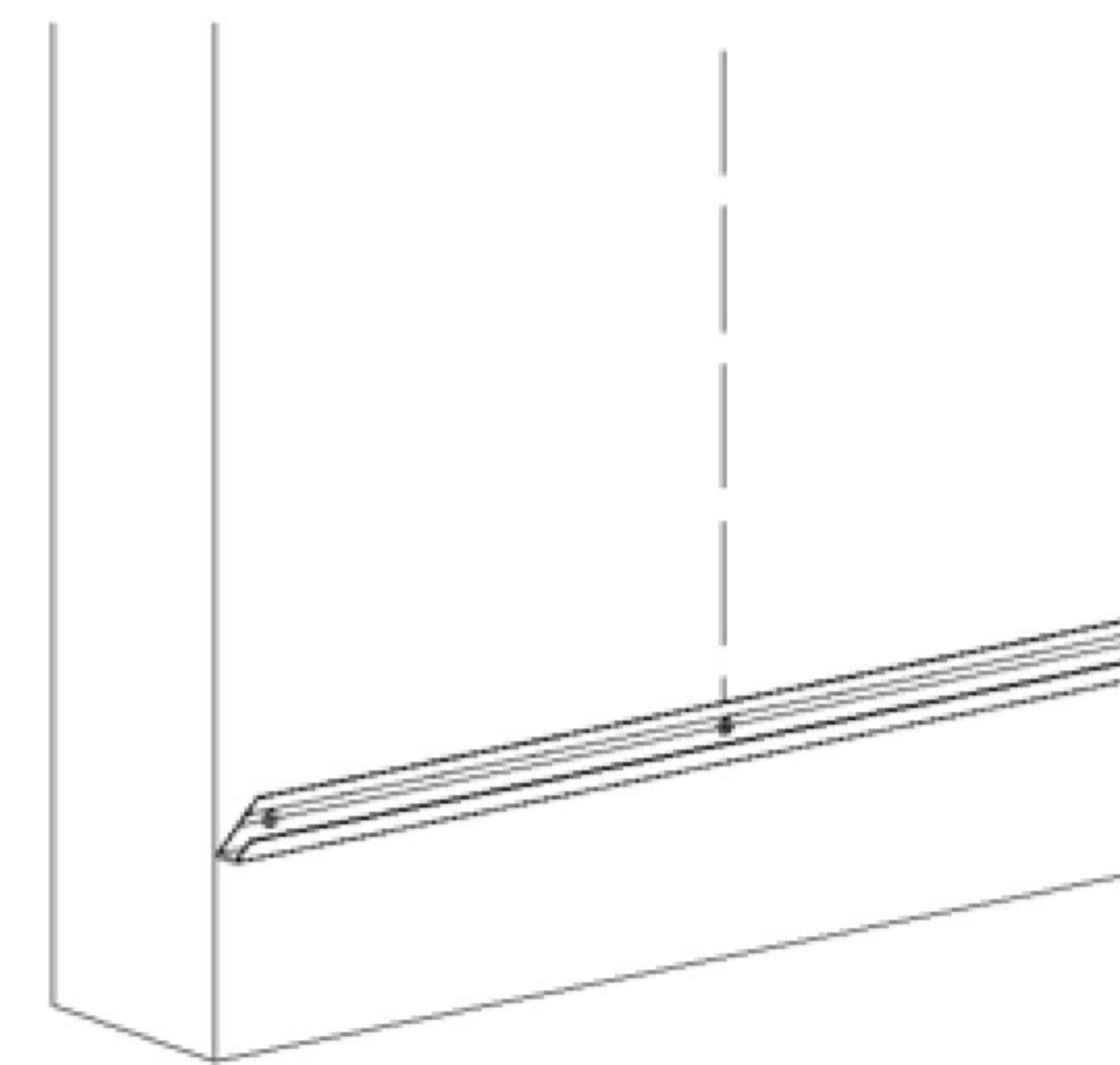

Miter finished ends

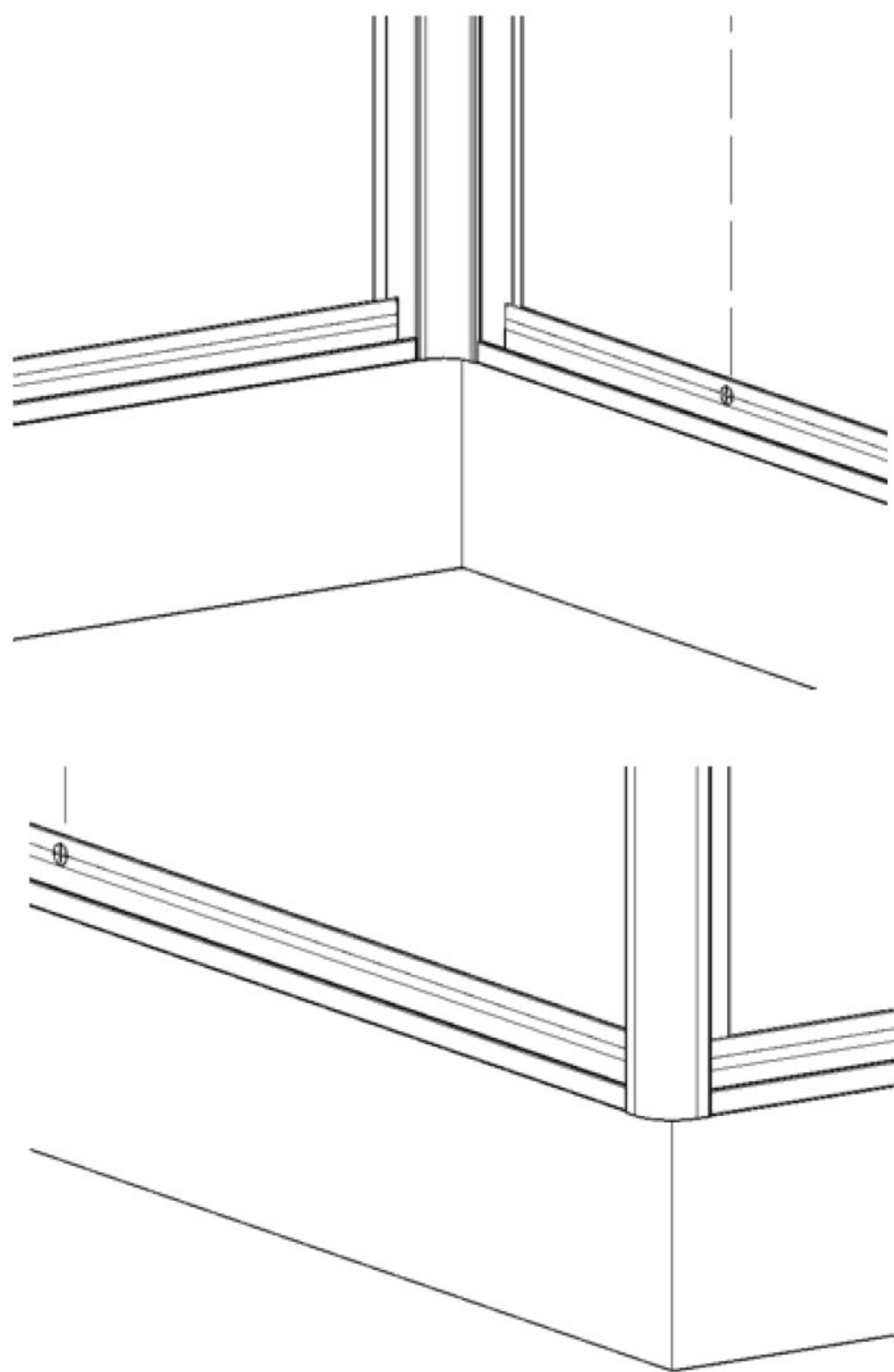

Bottom "J" track will slightly overlap inside and outside corners and should be seated tight at ends to the visible outside face of corner extrusions.

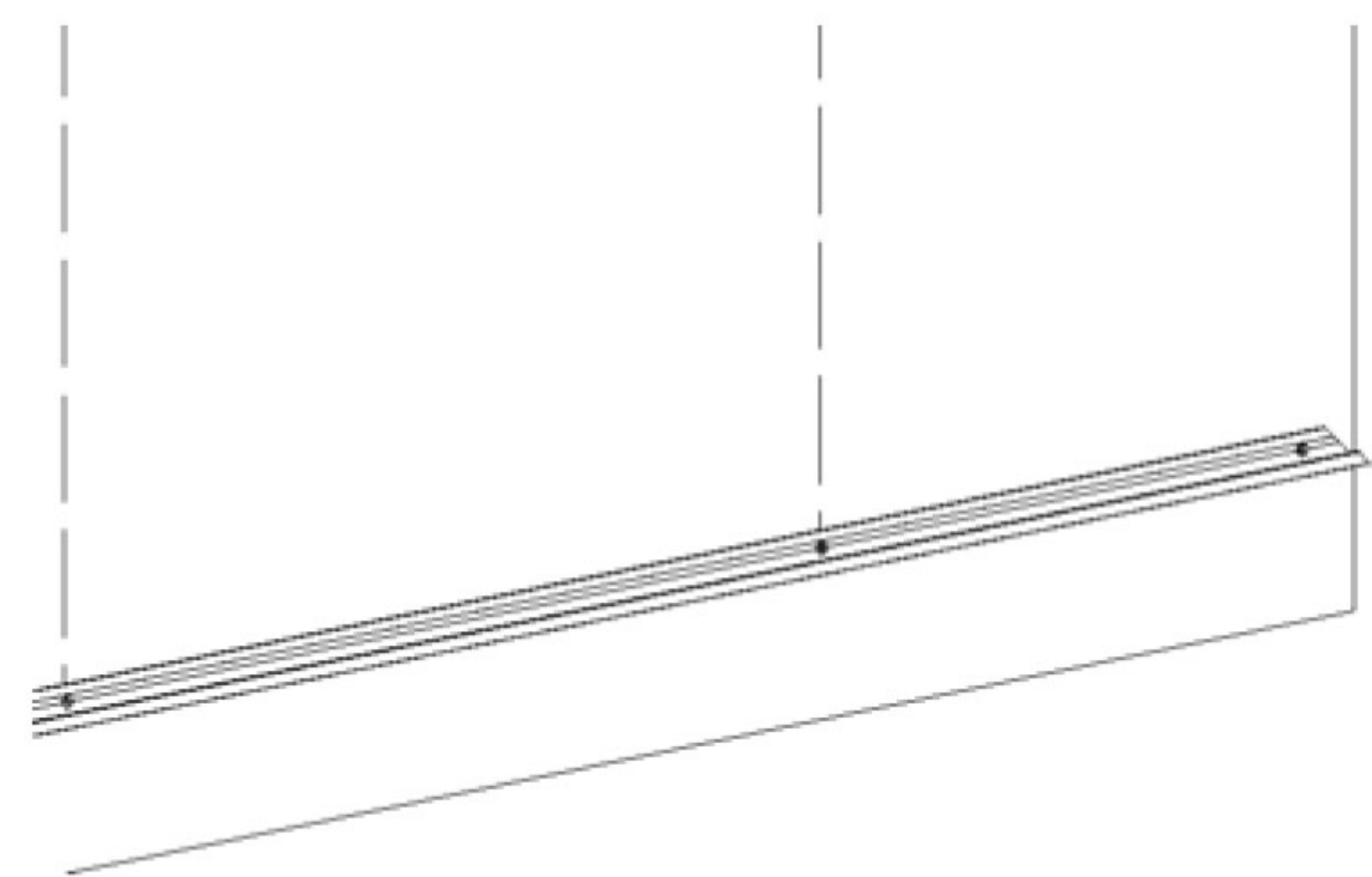

INSTALLATION GUIDELINES

DETERMINE WALL PANEL LAYOUT AND MOUNT VERTICAL "H" BAR & FINISHED END "J" TRACK

Once corner extrusions and bottom "J" track have been mounted a few determinations need to be made that will affect the overall look and affect how much cutting will have to occur to obtain the desired look. Understanding the working size of the panels and extrusions helps with pre-planning the layout before you begin installation.

The wall panels are in most cases pre-cut to a predetermined size as well as the "H" bar. The wall panels themselves can be used to space the vertical "H" or spacers can be cut. A piece of horizontal "H" should also be used to make sure it will fit between vertical extrusions. Strict attention should be paid to keeping the vertical "H" perpendicular with the bottom "J" track and plumb and level. In most cases the vertical "H" won't fall on a stud position so hollow wall anchors are required.

Three anchors in four feet are sufficient to retain each vertical "H" bar. Pre-drill the "H" bar and transfer the hole pattern to the wall surface and drive hollow wall anchors. Attach using #8 x 1 3/4 drywall screws.

In regards to planning and layout, the two examples below show the two possibilities in wall spans that are greater than 47 3/4" (Pre-cut panel size)

The example on the left shows the panel installed to the extreme right hand side and will require only one vertical "H" bar and one cut end panel to complete the run. The example on the right shows a centered and balanced panel that will require two vertical "H" bar and two equal balance panels cut and installed on the left and right. The desire to balance the wall panels between walls or in niches should be taken into consideration at the earliest planning stages so the desired look can be achieved as well as the correct amount of vertical "H" ordered.

Each wall should be measured so a rough determination can be made of the general size of fill panels at ends and whether its best to balance the wall panels with equal fillers at ends or if it doesn't effect the look or installation and a single fill panel will suffice. The longer a wall surface is the more apparent imbalanced wall panels become but if balancing the panels would produce end panels 3" or smaller at both ends the layout tends to look better with a 6" wall filler at one end instead.

Use a level to ensure vertical "H" is plumb

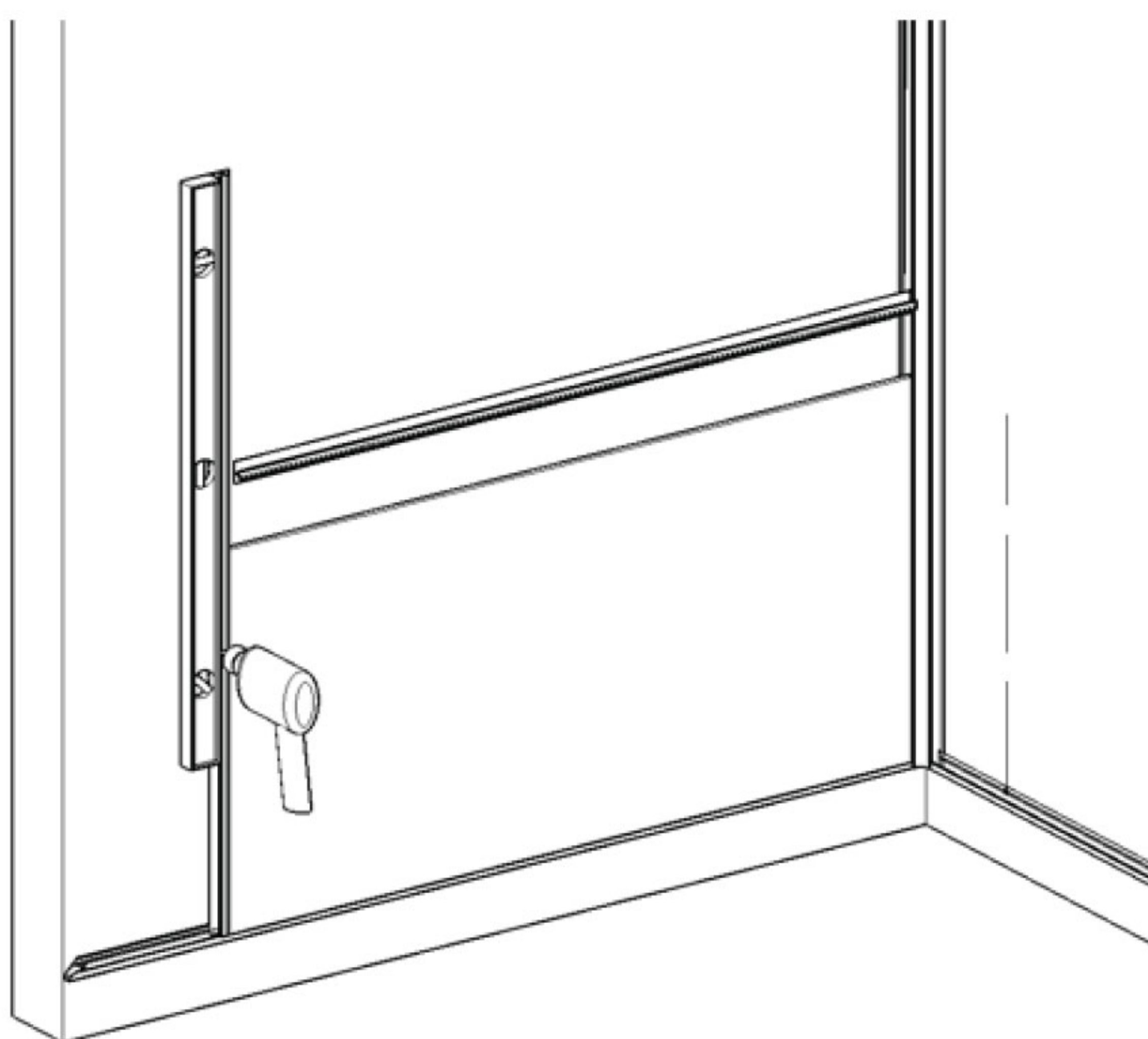

Use a piece of horizontal "H" bar to ensure it will fit after panels are installed



*Use hollow wall anchors
When no studs are available*

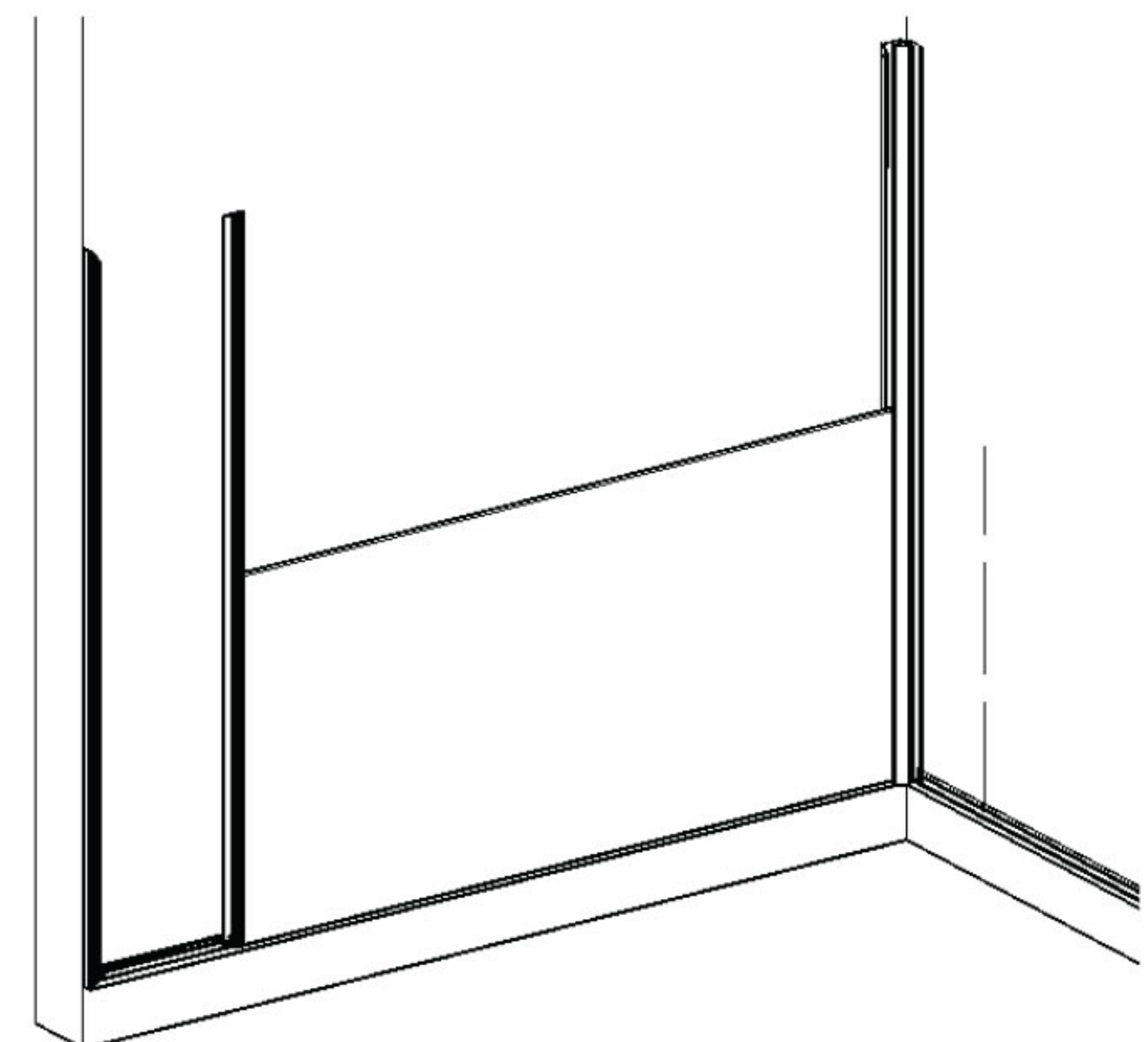

Wall with single cut end panel at one end

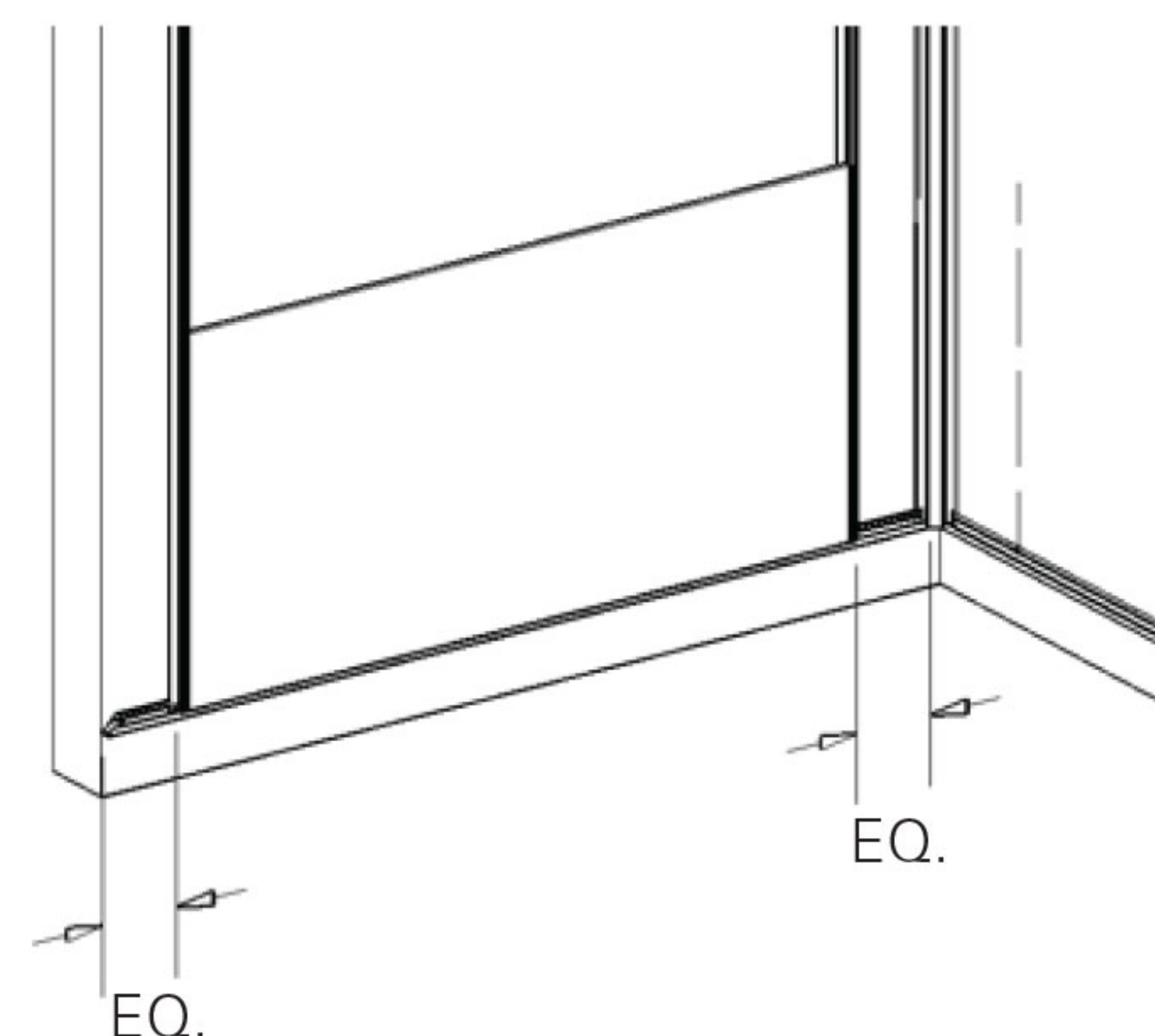

Wall with balanced panel and equal fillers at ends

INSTALLATION GUIDELINES

INSTALLING PANELS AND HORIZONTAL "H" BAR

Once corner extrusions, bottom "J" track, finished end "J" track and vertical "H" bar have been installed the system is ready to load wall panels. Installation at this stage goes extremely fast.

Install horizontal "H" on top of bottom tier panels, drill a pilot hole at stud locations and fasten with #8 x 1 3/4 drywall screws. One to two screws on each horizontal "H" is sufficient to secure the horizontal "H" bar. Small filler sections at ends don't require a screw in the horizontal "H" bar and can be locked in place with the panel above and a small application of construction adhesive.

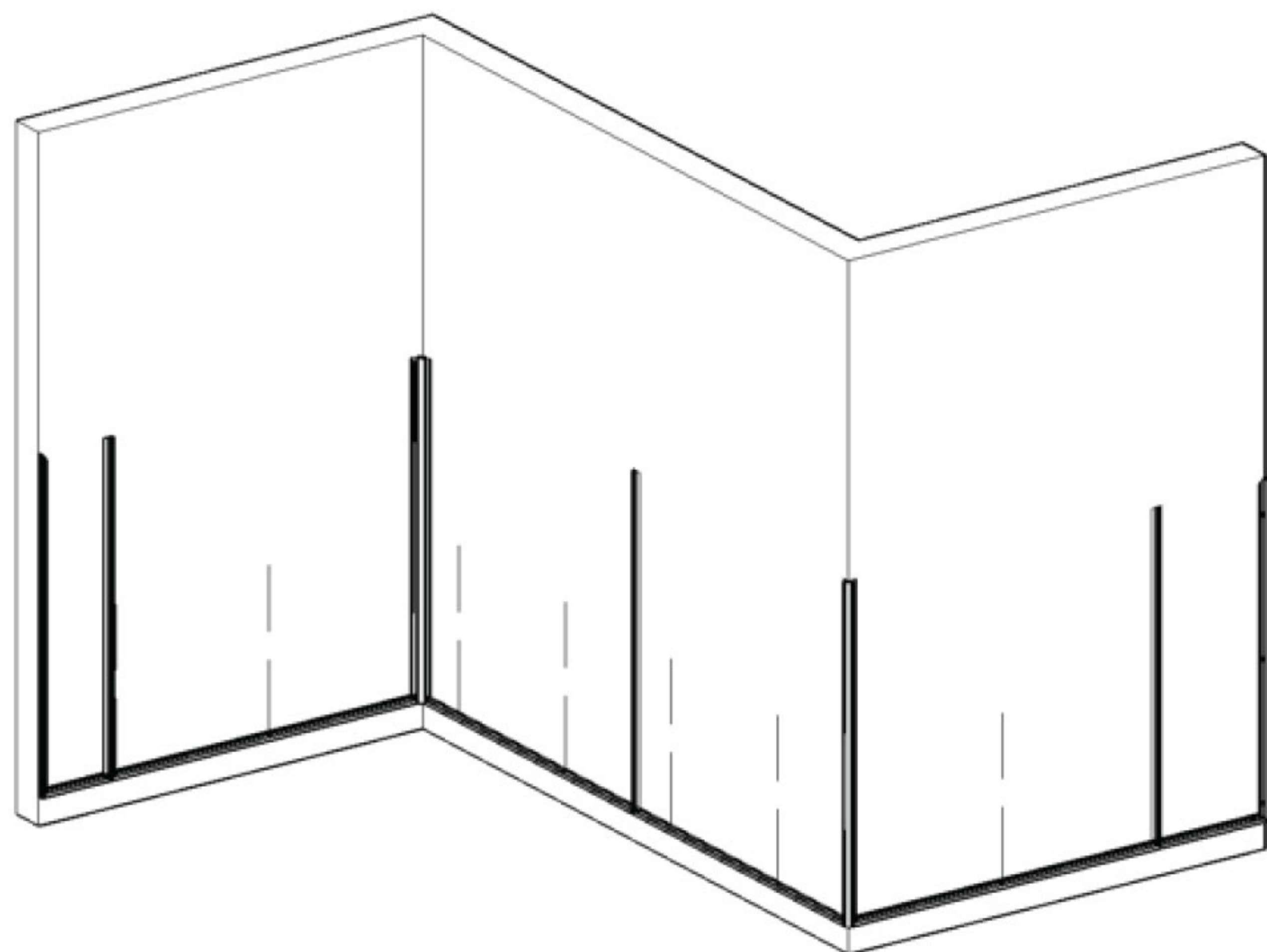

All vertical extrusions and bottom "J" are installed and ready for panels

Cut end fillers to width and load the lower tier panels from the top into all the vertical channels of the corner and "H" bar extrusions. Make sure the panels are all seated evenly across the bottom "J" track. In the example below a two tier panel system is shown, in those areas where a three tier system is desired the installation process is exactly the same only a longer vertical corner and "H" is required.

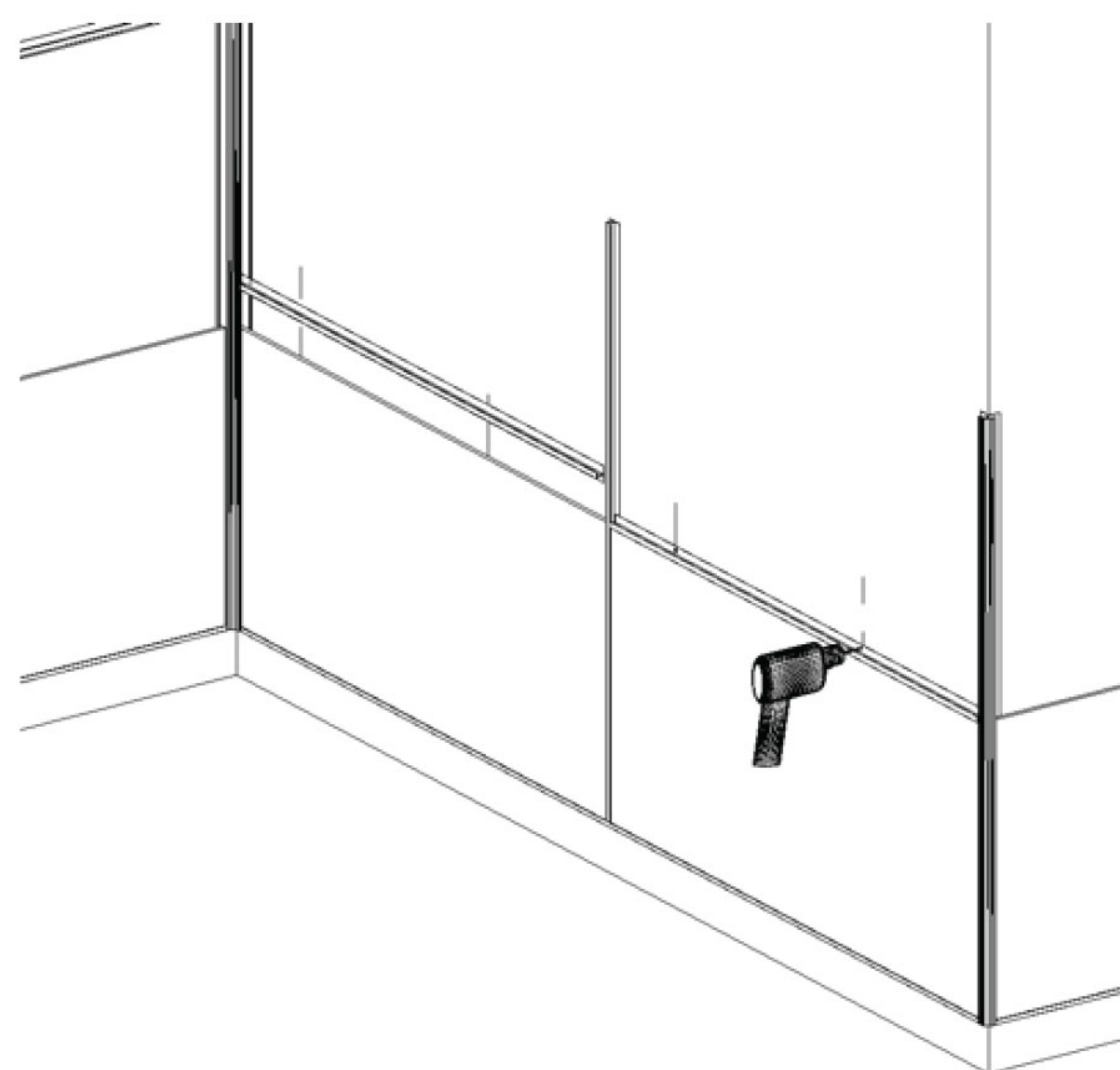

Install horizontal "H" bar on top of bottom tier panels and secure at stud locations

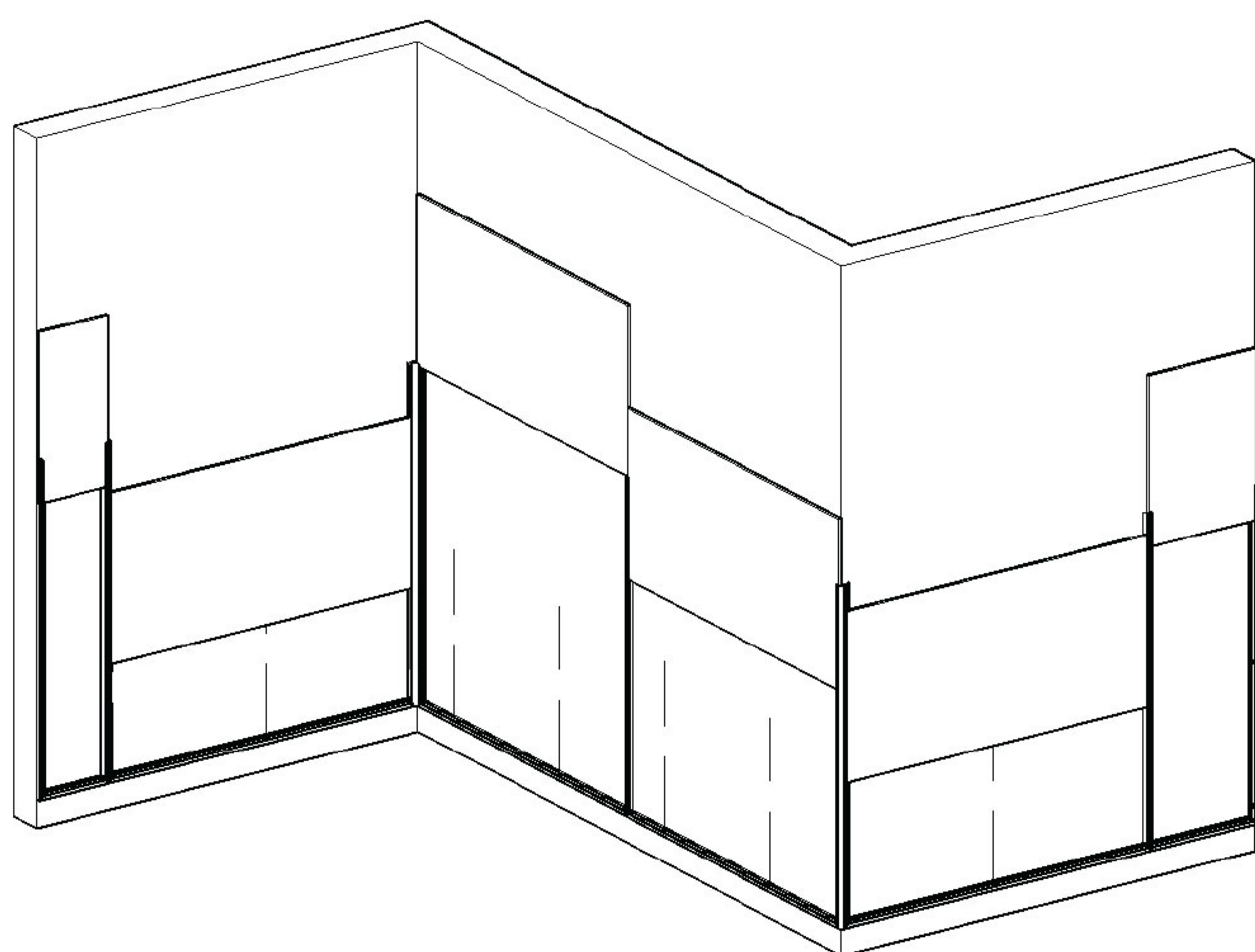

Load end panels and center panels in from the top, make sure they are even and seated well at the bottom

INSTALLATION GUIDELINES

Install top tier panels in the same fashion as the lower tier panels by sliding into corner and vertical "H" slots and seating the panels downward into horizontal "H".

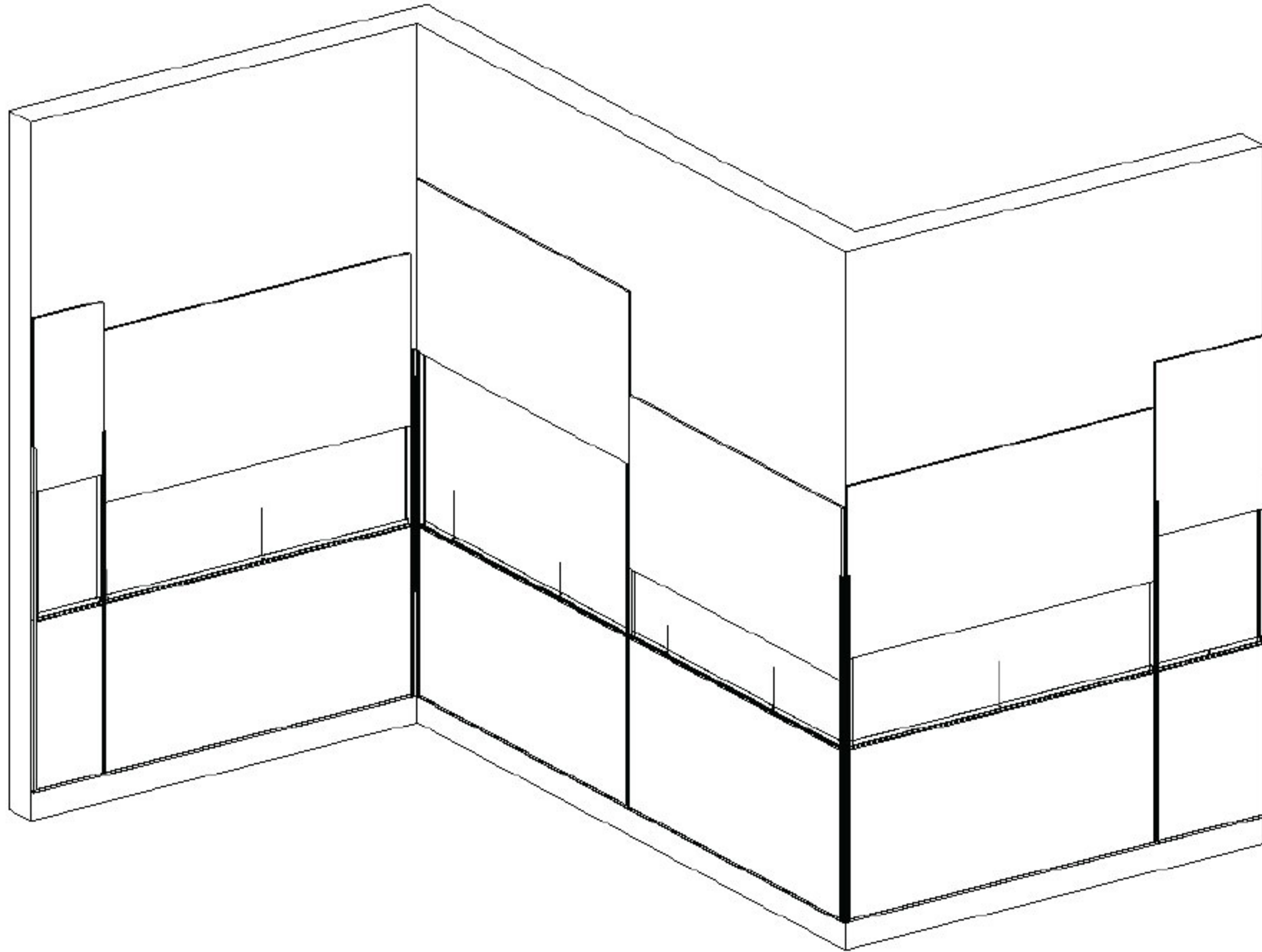

Install top tier panels and slide downwards to seat into center horizontal "H"

INSTALL UPPER "J" TRACK

Upper and lower "J" track pieces should be the same size, remember to always cut upper and lower "J" track in pairs if they have a mitered end and two pieces cut exactly the same for spans between inside and outside corners. Check fit and apply a 1/4" bead of clear silicone between wall and backside of upper wall panels and press "J" track into place. Use tape to hold in place if needed and apply additional bead of painter's caulk at top edge of wall and upper "J" if needed.

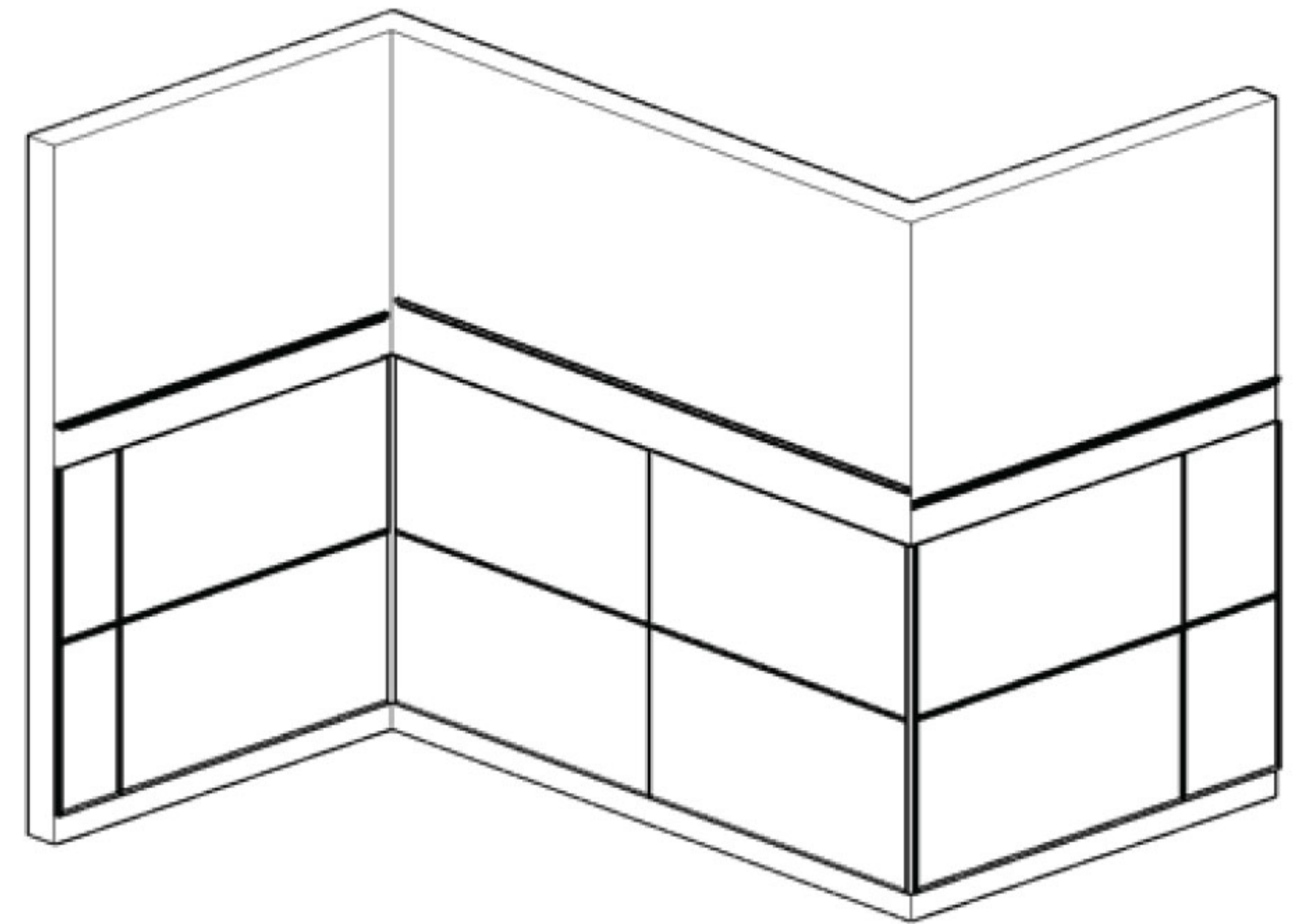

Install upper "J" track with clear silicone, use tape to hold in place if needed till dry



INSTALLATION GUIDELINES

INSTALL INSIDE AND OUTSIDE TOP CAPS

Apply generous amounts of clear silicone in the void areas on top of the inside and outside corners, make sure that the silicone is enough to make contact and a good bond with the bottom of the corner caps. Tape in place and leave till dry.

Inspect installation and make sure top caps and top "J" track have adhered properly, if secure the wall system is now ready for years of trouble free service.

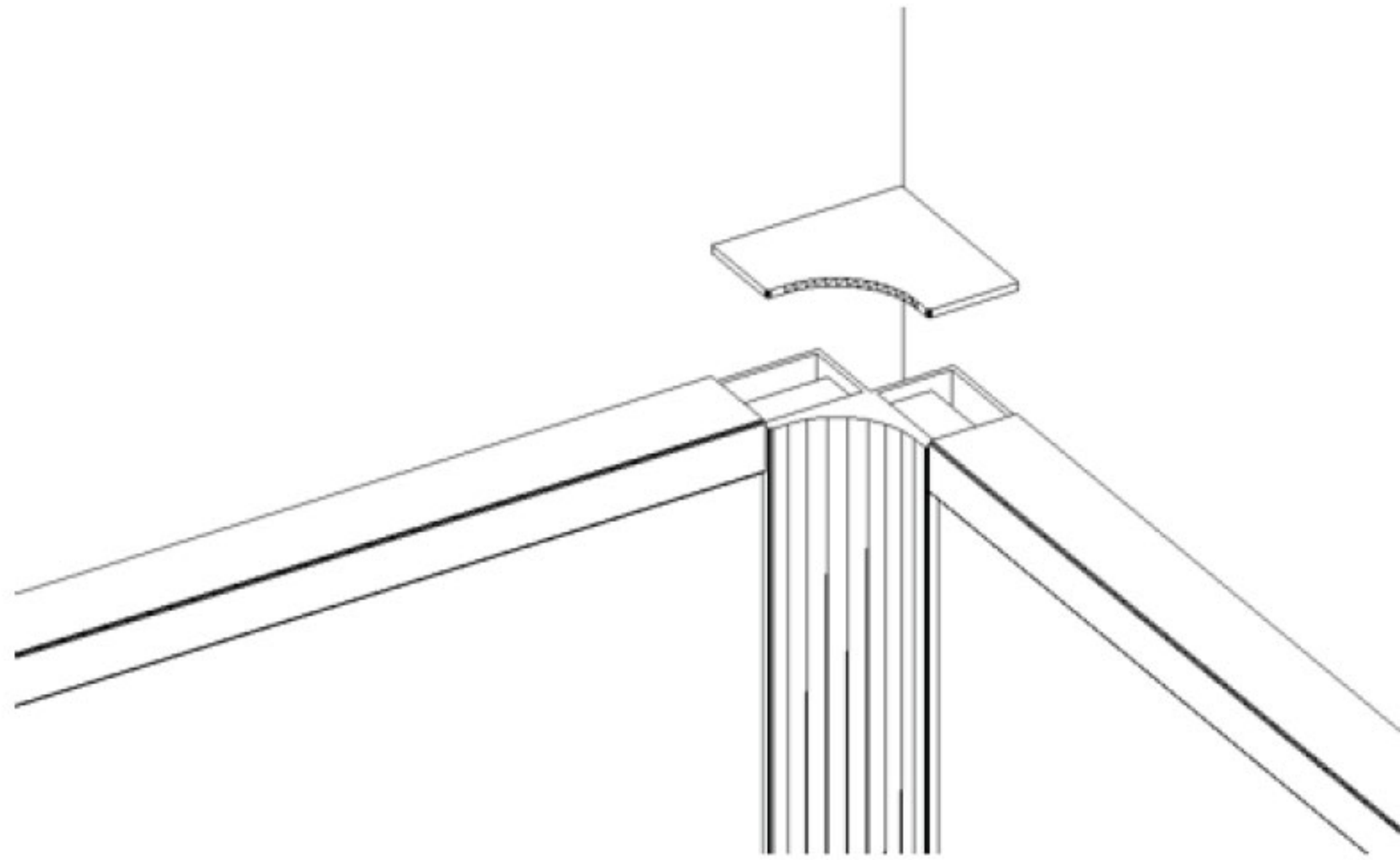

Install inside and outside corner caps with clear silicone, use tape to hold in place if needed till dry

