

Standard Body



PRODUCT FEATURES

- Wireless connectivity through BLE (Bluetooth Low Energy)
- IP55 rated, FCC, CE, and IC certified
- Brushed nickel or black finish
- Slim 0.33" (8.5mm) profile
- All metal housing
- Visual and audible indicators
- Advanced auto unlock
- ADA compliant
- Non-handed
- With or without pull handle
- Available in standard, vertical, or horizontal body type

FUNCTIONALITY

- Dual functionality - shared or assigned use
- Manage with the DigiLink cloud based network application
- Operate by User pin or Mobile ID

INSTALLATION

- Designed for both new or retrofit installations
- Adaptable to multiple door thicknesses
- 1/2" (12.7mm) motorized deadbolt locking mechanism
- Snap-lock cable connector (patented)

POWER

- Up to 5 years battery life with average use
- Powered by 4 premium AA batteries

SUPPORT

- On-site product updates
- Lifetime Support
- 2-year warranty

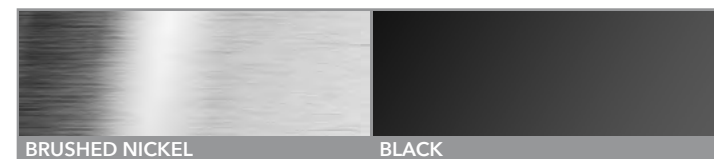

Standard Body

TOP VIEW

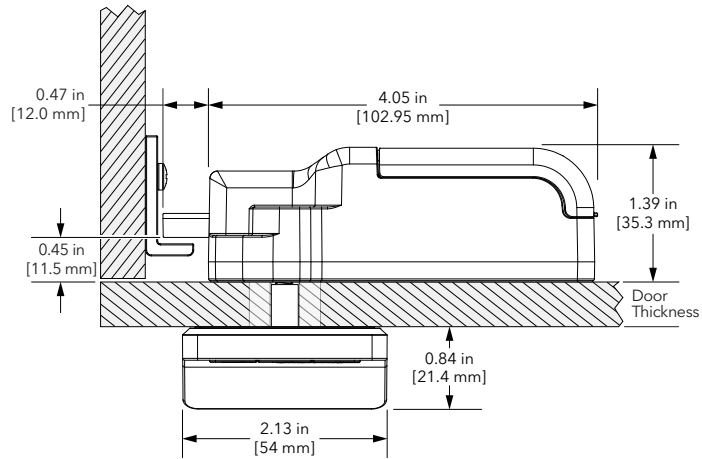

SIDE VIEW

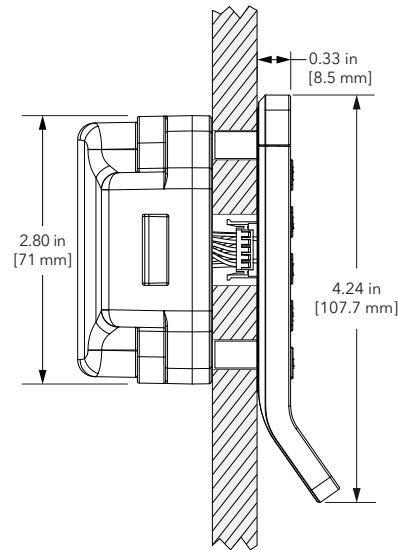

FRONT VIEW

