

PERFORMANCE, DURABILITY, AFFORDABILITY...

PLUS SUPERIOR HIGH LOAD BEARING CAPABILITY

**INTRODUCING** the New BIO-CHANNEL SB, the latest innovation by Robbins...

The All NEW BIO-CHANNEL SB System Benefits Include:

- Safe guards the well-being of the athlete
- Passes ALL global performance standards worldwide, including the stringent MFMA 3<sup>rd</sup> party certification, **PUR**, which is strongly governed by the MFMA
- Continuous interwoven subfloor design is perfect for carrying heavy loads
- System "bottoms" out on itself during heavy rolling or static loads
- Elongated anchor slots allow lateral movement to reduce build up of stress, maintaining structural integrity
- Anchored for dimensional stability and uniformity for long -term superior game play
- Computer-assisted manufacturing technology for quality assurance

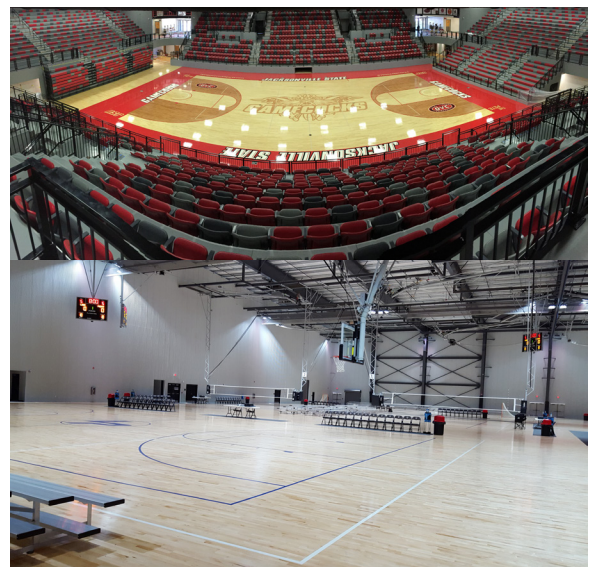
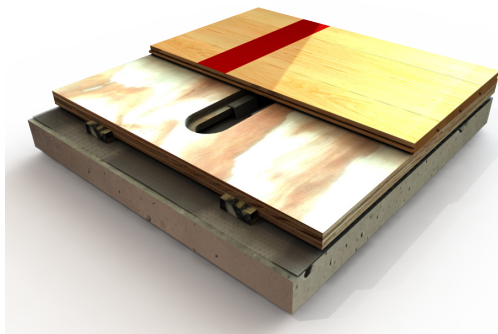

robbinsfloor.com | 1.800.543.1913

Robbins, Inc. | 4777 Eastern Avenue | Cincinnati, OH 45226

MAPLE FLOORING SYSTEMS

## Product Specifications

<b>System Type</b>	Anchored Resilient Panel
<b>Slab Depression</b>	1 3/4" (44mm) with 25/32" (20mm) maple
<b>Surface- MFMA Northern Hard Maple</b>	Robbins Continuous Strip® XL (FJ)
<b>Exceeds Industry Testing Standards:</b>	MFMA PUR DIN 18032 part 2 2001 DIN 18032 part 2 1991 ASTM F2772-09 FIBA Level 1 EN 14904 Type 4
<b>Anchorage</b>	Heavy Duty Anchor Spike with Metal Channel
<b>Subfloor Construction</b>	Nominal 3/4" x 48" x 96" subfloor sheathing that has factory prepared anchor slots & resilient padding slots
<b>Resilience Layer</b>	9/16" Zero/G® Shock Pad Strip
<b>Vapor Barrier</b>	6 MIL Polyethylene
<b>Optional Construction</b>	Contact a Robbins Representative for Alternative Systems
<b>LEED Contributions</b>	MR credit 4, 5, & 7 IEQ 4.1, 4.2, 4.3, 4.4 FSC® Lumber Available <i>*Credits are based on products selected and location of facility</i>



Wall View

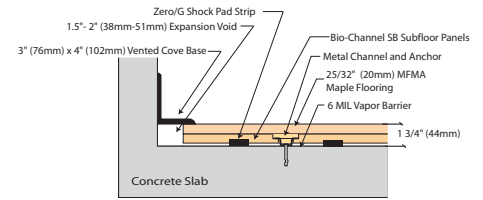

Threshold View

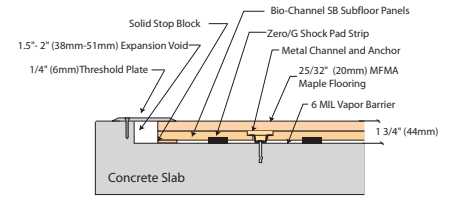

Equipment View

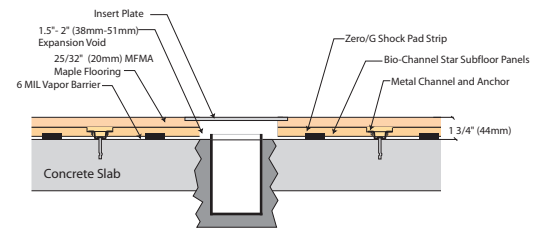

### **Bio-Channel SB Reference Facilities**

LakePoint Sporting Community  
Emerson, GA 120,000 sq. ft.

Valdosta State University  
Valdosta, GA 19,000 sq. ft.

Jacksonville State University  
Jacksonville, AL 9,800 sq. ft.

Letchworth CSD  
Gainesville, NY 7,300 sq. ft.

