

# BIO-CHANNEL® STAR

THE TOUGHEST SYSTEM....

JUST GOT A LITTLE TOUGHER

NEW  
&  
IMPROVED!

**INTRODUCING** the New & Improved BIO-CHANNEL STAR, the latest innovation by Robbins that now meets ALL performance standards **WORLDWIDE!**



Robbins has redefined uniformity & performance by improving the Bio-Channel Star system to pass ALL global performance standards worldwide, including the stringent MFMA 3<sup>rd</sup> party certification, PUR, which is strongly governed by the MFMA. PUR was designed utilizing exacting testing methodologies, to ensure that customers receive a reliable, well performing, competitive sports surface. Bio-Channel Star is great for new construction and renovation facilities!

## NEW & IMPROVED BIO-CHANNEL STAR System Benefits:

- Improved shock absorption & ball bounce for improved player performance
- Continuous subfloor and continuous resilient pad provides vibration damping/control & uniformity for improved comfort
- Anchored subfloor interwoven design is perfect for heavy loads & allows lateral movement to reduce stress, maintaining structural integrity
- Computer-assisted manufacturing technology for quality assurance

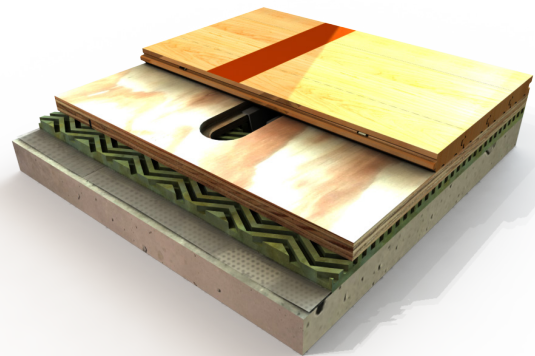

**Robbins**

PROUD TO BE  
  
MADE IN THE USA





robbinsfloor.com | 1.800.543.1913

Robbins, Inc. | 4777 Eastern Avenue | Cincinnati, OH 45226

MAPLE FLOORING SYSTEMS

# BIO-CHANNEL® STAR

## Product Specifications

 <b>System Type</b>	Anchored Resilient Panel
 <b>Slab Depression</b>	2 1/8" (54mm) with 25/32" (20mm) maple 2 3/8" (60mm) with 33/32" (26mm) maple
 <b>Surface- MFMA Northern Hard Maple</b>	Robbins Continuous Strip® XL (FJ)
 <b>Exceeds ALL Industry Standards:</b>	MFMA PUR DIN 18032 part 2 2001 DIN 18032 part 2 1991 ASTM F2772-09 FIBA Level 1 EN 14904 Type 4
 <b>Anchorage</b>	Anchor Spike with Metal Channel
 <b>Subfloor Construction</b>	Nominal 3/4" x 24" x 96" subfloor sheathing that has factory prepared anchor slots
 <b>Resilience Layer</b>	9/16" Profiled Zero/G® Shock Pad
 <b>Vapor Barrier</b>	6 MIL Polyethylene
 <b>Optional Construction</b>	Contact a Robbins Representative for Alternative Systems
 <b>LEED Contributions</b>	MR credit 4, 5, & 7 IEQ 4.1, 4.2, 4.3, 4.4 FSC® Lumber Available <i>*Credits are based on products selected and location of facility</i>



Wall View

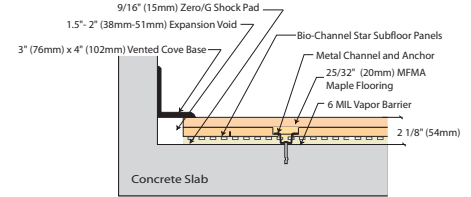

Threshold View

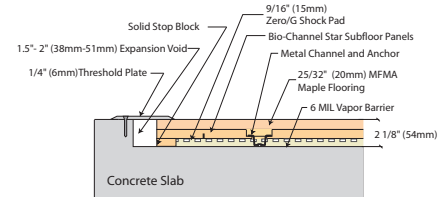

Equipment View

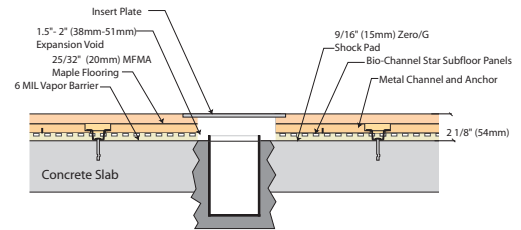

### Bio-Channel Star Reference Facilities

- Comite Olimpico- Chile
- SMU Practice Facility
- Cleveland State University
- Davenport University
- Ball State University
- Alcorn State University



robbinsfloor.com | 1.800.543.1913

Robbins, Inc. | 4777 Eastern Avenue | Cincinnati, OH 45226